



**TOWN & COUNTRY** elevation shown with included cultural stone.

# THE BROOKDALE II MULTI-GENERATION FLOORPLAN

Updated February 4, 2024

**MAIN HOME:** 1.5 Story • 2,482 sq.ft. • 3 Bedrooms • 1st Floor Master Suite • 3 Baths • Dining Room • Media Loft • 2 Car Garage

**MULTI-GEN HOME:** 1 Story • 640 sq.ft. • 1 Bedroom • 1 Bath • Living Area

**OPT. GREAT ROOM EXPANSION**  
ADD. 124 sq.ft.

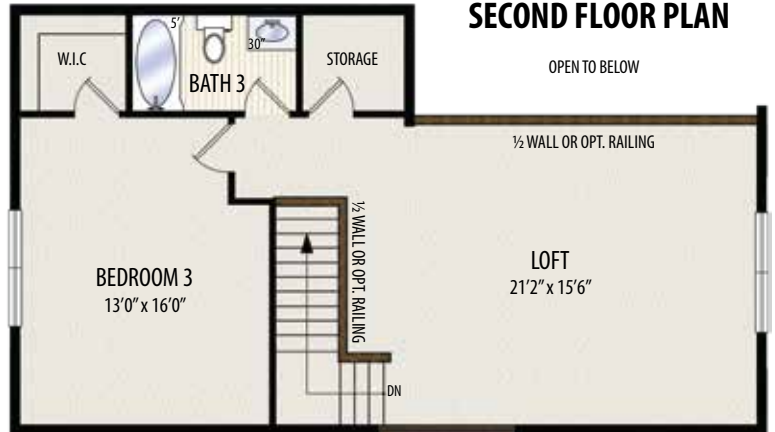

## SECOND FLOOR PLAN

## FIRST FLOOR PLAN



**TOWN & COUNTRY ELEVATION**



**Marketing Disclaimer:** The renderings and visual media used in our marketing are for illustrative purposes only. They depict options and upgrades that are available to purchase but may not be included in the standard feature package. For a full list of our models, standard features and available options contact a member of our sales team. All plans and specifications are believed correct at time of publication, however accuracy is not fully guaranteed. All dimensions, sizes, and descriptions shown are approximate. Listed sq.ft. is based on heated space. Amedore Homes et al, reserves the right to revise content without notice or obligation.

©Amedore Homes, Inc 2024

518.456.1010  
amedorehomes.com

**Amedore** INC.  
**HOMES**  
*Surround Yourself with Excellence!*